

SECTIUNE LONGITUDINALA / LONGITUDINAL SECTION A-A
Sc 1:100

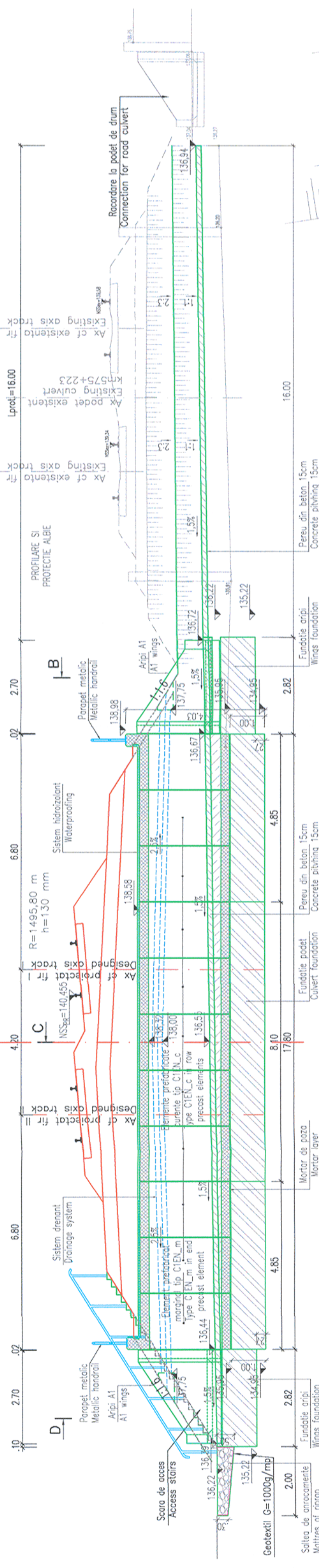

VEDERE IN PLAN SI PLAN FUNDATII / PLAN VIEW AND FOUNDATION PLAN
Sc 1:100

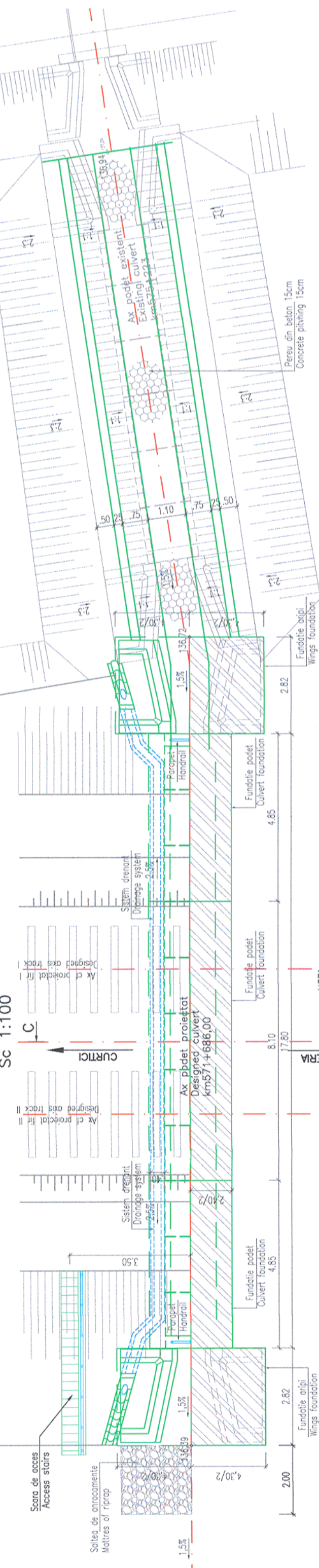

LEGENDA BETOANELOR/CONCRETE LEGEND
conform NE 012-1:2007/SR EN 206-1

- BETON C35/45 - Clasa de expunere XC4+XD1+XF3, agregate D_{max} 22 ELEMENTE PREFABRICATE/PREFABRICATED ELEMENTS
- BETON C25/30 - Clasa de expunere XC2+XF1+XA1, agregate D_{max} 22. FUNDATII DIRECTE SI FUNDATII PROVIZORII/DIRECT FOUNDATIONS AND TEMPORARY FOUNDATIONS
- BETON C25/30 - Clasa de expunere XC4+XF3, agregate D_{max} 22. ELEVATI SI ZIDURI DE SPRUIN/ELEVATIONS AND RETAINING WALLS
- BETON C25/30 - Clasa de expunere XC4+XF1+XM1, agregate D_{max} 16. SAPA DE PROTECTIE A HIDROIZOLATIEI/WATERPROOFING PROTECTION
- BETON C25/30 - Clasa de expunere XC4+XF3+XA1, agregate D_{max} 22. PEREU, SCARI DE ACCES , PITVING ACCESS STAIRS
- BETON C16/20 - Clasa de expunere XD+XF3, agregate D_{max} 16. DREN, BETON DE PANTA SI DE EGALIZARE DRAINAGE, SLOPE AND LEAN CONCRETE

NOTA:
1. Prezentul plan s-a intocmit in baza urmatoarelor date:
- studiu topografic;
- studiu geotehnic;
- studiu hidrologic;
- expertiza tehnica;
- date culesse pe teren

2. Pentru asigurarea surgerii apelor pe zona traseului si nou proiectat se vor executa urmatoarele lucrari:
- se va executa un podet nou de tip C1EN;
- racordarea podetului nou cu terasamentele va fi asigurata in amonte si aval cu aripi prefabricate tip A1EN;
- se vor impermeabiliza suprafețele de beton vizibile;
- se prevede parapet metalic la ambele capete ale podetului de la cf;
- se prevede scari de acces pe terasament, de o parte si alta a podetului;
- se va amenaja albia in interiorul podetului si intre aripi cu peruu de beton;
- soseaua de 2,00m lungime, din piatra bruta in aval la capatul perelui;
- in amonte si aval se va racorda albia naturala.
3. La turnarea betonului in fundatii, se vor realiza rasturii totale. Rasturile din fundatii se vor suprapune resturilor intre cadrele prefabricate minimum din trei in trei cadre.
4. La executie se vor respecta cu stricte prevederile din SR EN 206-1, "Codul de practica pentru executarea lucrarilor din beton, beton armat si beton precomprimat/Producere beton", indicativ NE 012-1:2007 si NE013/2002, din "Normativul pentru verificarea calitatii si receptia lucrarilor de constructii alerente" indicativ C56-85 si a Caietului de Sarcini.
5. Conform H.G. 766/1997 lucrarea se incadreaza in categoria "B" a constructiilor de importanta deosebita.
6. Proiectul va fi verificat de verificatori atestati M.P.A.T la exigentele A.4, B.2 si D.2.

NOTA:
1. This plan was prepared based on the following data:
- topographic study;
- geotechnical study;
- hydraulic study;
- technical expertise;
- data collected on site.

2. In order to ensure the water discharge on the area of the new railway designed route, the following works will be executed:
- the execution of a new railway culvert type C1EN;
- the connection of the new culvert with the embankments will be carried out upstream and downstream by help of precast wings type A1EN;
- The visible surfaces of concrete will be waterproofed;
- metallic handrail is provided at both ends of the railway culvert;
- access stairs are provided on the embankment, on one side and the other of the culvert;
- the riverbed will be arranged inside the culvert and between wings with concrete pitching;
- 2,00m long mattress made of rough stone at both ends of the pitching;
- the natural riverbed will be connected upstream and downstream.
3. When casting the concrete in the foundations, total joints will be executed. The joints in the foundations will be overlapped with the joints between the precast frames at least every three frames.
4. When executing, there will be strictly observed the provisions of SR EN 206-1, "Code of practice for the execution of concrete, reinforced concrete and prestressed concrete works. Concrete manufacture", indicative NE 012-1:2007 and NE013/2002, out of "Normative for quality checking and taking over the different construction works" indicative C56-85 and of the Technical Specifications.
5. Complying with H.G. 766/1997 this structure belongs to category "B" of importance.
6. The project will be verified at A.4, B.2 and D.2 requirements.

OBSERVATIE: Pe toate suprafețele din beton in contact cu pamantul se vor aplica 2 straturi de emulsie din bitum fierizat.
ATTENTION: All concrete surfaces in contact with soil will be coated with 2 bituminous layers.

CONVOI DE CALCUL LM71
CALCULATION CONVOY LM71

PLANURI DETALII GENERALE / GENERAL DRAWING DETAILS

ACOPERIRE ROSTURII ELEMENTE PREFABRICATE JOINTS COVERING PRECAST ELEMENTS	P	T	0	2	0	2	0	0	0	1
HIDROIZOLATIE SI SISTEM DE DRENARE PODETE WATERPROOFING AND DRAINAGE SYSTEM CULVERTS	P	T	0	2	0	2	0	0	0	2
PARAPET METALIC PODETE METALLIC HANDRAIL CULVERTS	P	T	0	2	0	2	0	0	0	3
PLAN COFRAJ CADRU TIP C1EN_m SHUTTERING PLAN FRAME TYPE C1EN_m	P	T	0	2	0	2	0	0	0	7
PLAN COFRAJ CADRU TIP C1EN_c SHUTTERING PLAN FRAME TYPE C1EN_c	P	T	0	2	0	2	0	0	0	8
PLAN COFRAJ ARIPI TIP A1EN SHUTTERING PLAN WING A1EN TYPE	P	T	0	2	0	2	0	0	0	1
SCARA DE ACCES SI BALUSTRAZA METALICA ACCESS STAIRS AND METALLIC BALUSTRADE	P	T	0	2	0	2	0	0	0	2

SECTIUNE B-B/
B-B SECTION
Sc 1:100

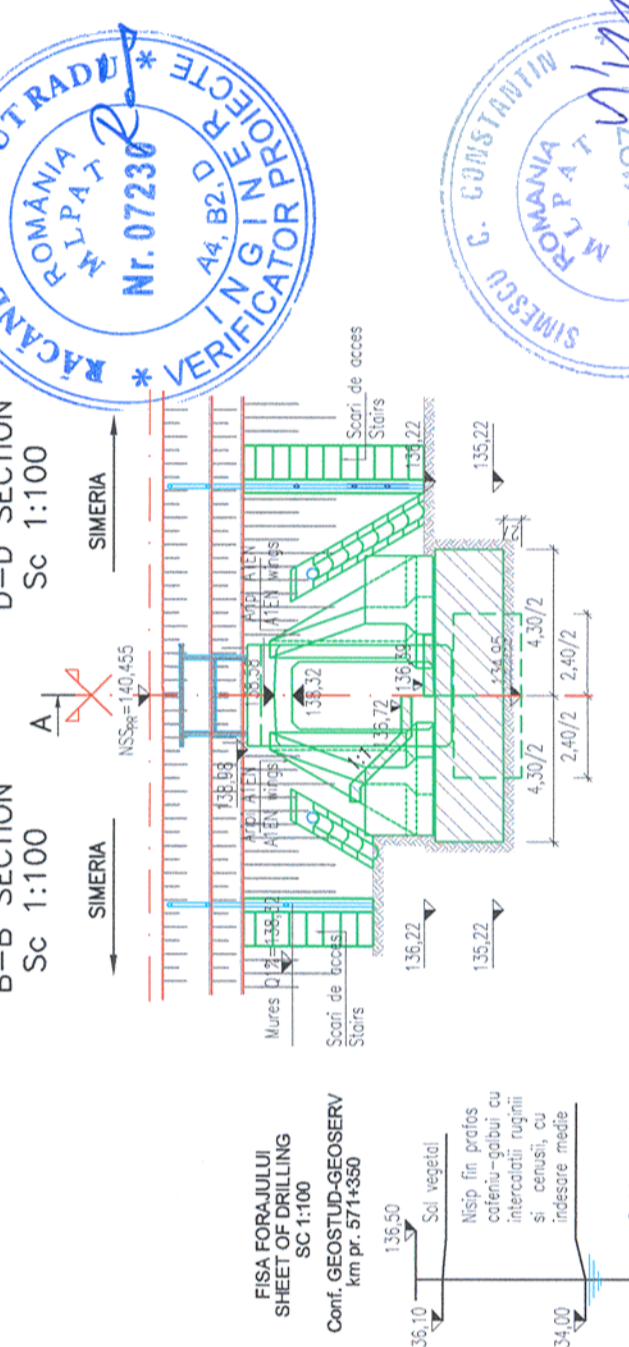

SECTIUNE C-C/
C-C SECTION
Sc 1:100

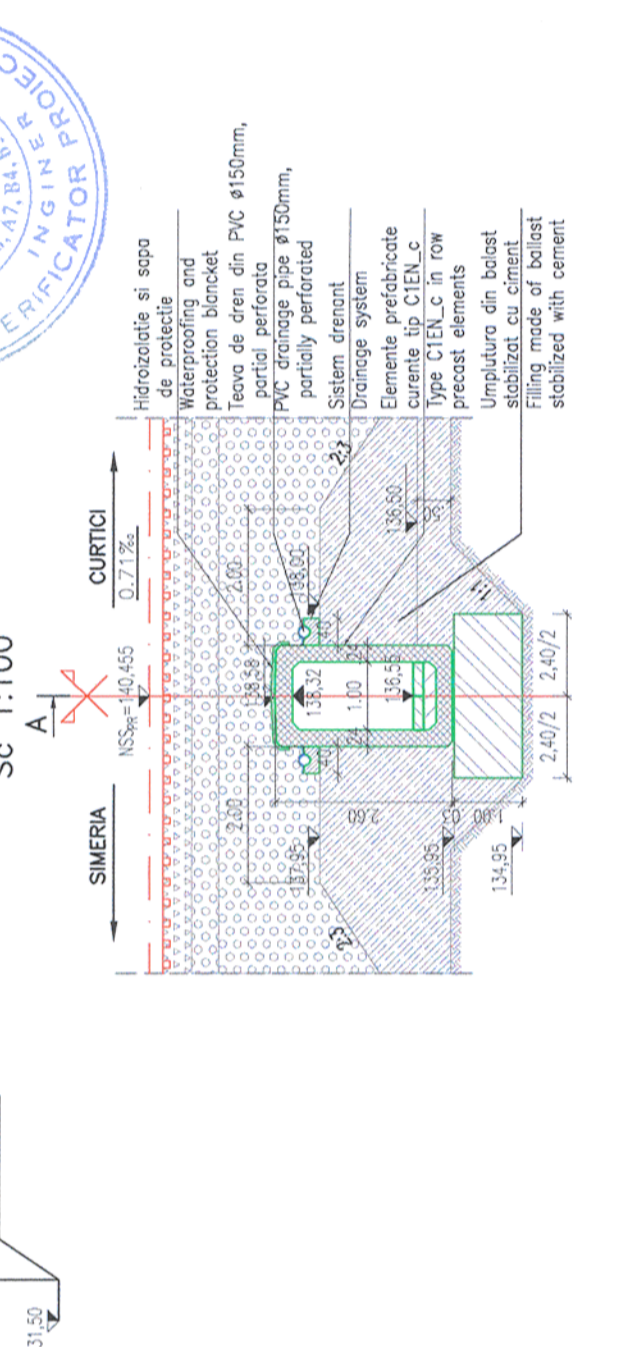

Prezentul plan anuleaza si inlocuieste versiunea anterioara
This plan cancels and replaces previous version

VERIFICATOR
INGINER
PROIECTE
Nr. 07230
M.P.A.T.
ROMANIA
A4, B2, D2

VERIFICATOR
INGINER
PROIECTE
Nr. 1107
M.P.A.T.
ROMANIA
A4, A7, B4, B5

Referat / Expertiza
Report / Expertise

MINISTERUL
TRANSPORTURILOR
BENEFICIAR / BENEFICIARY :
COMPANIA NATIONALA DE CAI FERATE "CFR" SA

PROIECTANT / DESIGNER:
PÖYRY

SEMNATURA
Signature

APROBAT
Approved
Verificat
Checked
Subcontractant / Subcontractor

SEMNATURA
Signature
Data
Date

SEMNATURA
Signature
Data
Date

SEMNATURA
Signature
Data
Date